

E1065 INDICATOR



Standard Fieldbus Interfaces

- ▷ Ethernet 10/100
 - ModBus/TCP
 - TCP/IP
 - SMTP
 - DHCP
 - Ethernet/IP™
- ▷ PROFIBUS® DP
- ▷ DeviceNet™

THE evolution™ SERIES

The Power of Intelligence

Just one instrument with so much capacity for work

One way to gauge the value of a weighing instrument is to measure its ability to grow and adapt to new processes. The Model E1065 indicator/controller measures up to this challenge by its ability to grow with your needs and switch easily from job to job.

Control and communication

Easy to use in general weighing applications, the Model E1065 combines the capabilities of process control interface and data management.

Uncomplicated, the E1065 provides process control and data management to most standard and custom-configured weighing platforms using bench and floor scales.

With the advantage of the built-in network interfaces (Ethernet 10/100, PROFIBUS® and DeviceNet™), the indicator/controller is ideally suited for sharing data in tank weighing and truck scale applications.

In addition to offering these interfaces, the E1065 connects to printers, remote displays, computers and SensorComm™, the Avery Weigh-Tronix microprocessor-based digital junction box. This connectivity provides unparalleled flexibility to truck scales and batching Weigh Bar® systems.

An additional feature is the E1065's bright multi-colored LED display with 0.8" digits, which allows operators to view weights with a quick glance.



Model E1065 provides control information to PLC and transmits data via built-in Ethernet, DeviceNet, PROFIBUS DP.

Specialized Applications

Checkweighing: The display includes a multi-segment fan graph for fast evaluation so operators can instantly verify that products are within target ranges or above or below acceptable tolerances.

Counting routines: The E1065 can display the number of pieces or average piece weight along with gross, net or tare weights.

Peak weight: If a maximum weight reading is required, the E1065 can capture and display the peak measurement of stable weights.

Process control: The indicator is equipped with three setpoint controls to interface with relays for automated mixing or blending operations.

Added Performance Features

- ▷ The Model E1065 can serve as a remote display in applications where weights must be read in two locations.
- ▷ Weight information can be transmitted to peripheral printers and/or computers through the indicator's dual communication ports. Information format may be customized and can include time and date.
- ▷ An IP54-rated enclosure when panel mounted ensures reliable, continuous operation in dusty environments.
- ▷ An optional remote foot control can be added for improved efficiency in common "lift and weigh" applications, giving the operator hand-free control of common scale functions (Zero, Print, Tare, Units or F-1).

The optional rack mount kit provides the perfect dimensional fit for those applications.

Avery Weigh-Tronix

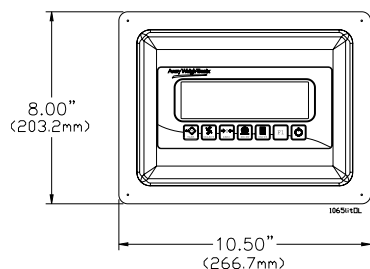

Front View and Dimensions

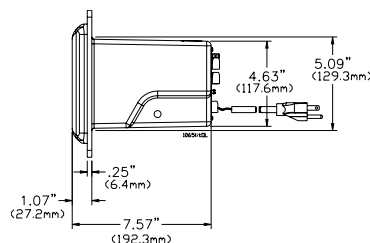

Side View and Dimensions

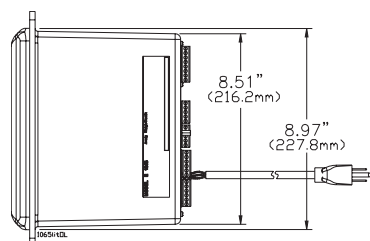

Top View and Dimensions

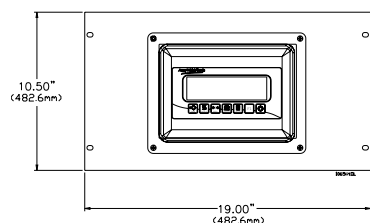

Rack Mount Front View and Dimensions



AUTHORIZED DISTRIBUTORS

Avery Weigh-Tronix distributors are complete support centers, providing needs assessment, technical information, product sales and service. Call or visit www.wtxweb.com for your nearest Avery Weigh-Tronix distributor.

Power requirements

- 85-265 Volts AC @ 0.3Amp maximum
- 50/60 Hz

Excitation

- +/- 5 volts DC
- Supports up to eight 350-ohm weight sensors

Analog signal input range

- +/-60 mV

Analog signal sensitivity

- 0.2 μ V/V/divisions minimum
- 1.0 μ V/V/divisions recommended

Calibration

- 2 to 5 points stored

Operational keys

- Seven keys:** Tare, Select, Zero, Print, Units, F1, On/Off

Operational annunciators

- Center of Zero, Motion, Gross, Net, Tare,
- Under/Target//Over
- Units of measure (LB, KG)
- Print, OP1, OP2, OP3, Pt Tare

Display

- Six-digit, seven-segment, 0.8-inch high, LED

Display rate

- Selectable (1, 2, 5, 10)

Analog to digital conversion rate

- 100 times per second

Unit of measure

- Pounds, kilograms, custom

Capacity selections

- 999,999 with decimal located from zero to five places

Incremental selections

- Multiples and sub-multiples of 1, 2, 5

Programmable selections

- Zero range, motion detection, automatic zero tracking, five-point linearization.

Time and date/RAM

- Battery backed up real time clock and RAM standard

Internal resolution

- 53,687,100 counts per mV/V per second

Harmonizer™ digital filtering

- Fully programmable to ignore noise and vibration

Standard inputs

- Three logic level inputs for:** Zero, Print, Tare, Units and F1

Standard outputs

- 10/100 Ethernet (Modbus/TCP, TCP/IP, SMTP, DHCP, Ethernet/IP)
- PROFIBUS DP
- DeviceNet
- Two serial ports
 - RS-232/422/485, SensorComm
 - RS-232 or 20mA current loop
- Three cutoff outputs

Serial Command Inputs/Outputs

- Programmable serial response to ASCII character input
- SMA protocol, Broadcast
- 22 configurable print formats

Self diagnostics

- Display, keys, inputs, outputs, serial port, A to D converter

Circuitry protection

- RFI, EMI, and ESD protection

Options

- Analog output/Pulse input
- ControlNet™
- Remote foot control
- Rack mount kit
- Desk stand kit
- TIU3

Operating applications

- General weighing with accumulation, Batching, Counting, Check weighing, Peak measurement, Remote display

Operating temperature

- 14 to 104° F (-10 to 40° C) NTEP
- 40 to 140° F (-40 to 60° C) non-legal
- Up to 95% noncondensing humidity

Enclosure

- Composite, IP 54 when panel mounted

Dimensions

- 10.5" W x 8" H x 7.75" D (without mounting bracket)
- 10.5" W x 11" H x 8.25" D (with mounting bracket)

Weight

- 4.5 lb, 2kg

Agencies

- NTEP** CC#04-031
Class III/IIIL:10,000 divisions
- OIML Certificate Number**
R76/1992 - GBI - 04.10
Class III:10,000 divisions
- Canadian Weights and Measures pending
- UL/CUL
- CSA
- CE marked

Avery Weigh-Tronix



Fairmont, Minnesota U.S.A.

USA Toll-free: 800-368-2039

USA Phone: 507-238-4461

www.wtxweb.com

Specifications are subject to change in accordance with technical modification.
12/04 E1065_spec.qxd PNO9943-0019

Pointe Claire, Quebec Canada

CAN Toll-free: 800-561-9461

CAN Phone: 514-695-0380

www.weigh-tronix.ca