

Truck Scale Plate Base Options

Effective January 29, 2004, Avery Weigh-Tronix offers a convenient method of increasing the profile of a truck scale installation.

The standard profile as illustrated on our foundation drawings is 14" (top of pier to top of approach). This provides the following clearances under the scale: BMS(3 1/2"), BMC(4"), IMXT(3 3/8"), FCXT(3 3/4").

Some states require additional clearance and some customers prefer more clearance than provided by the 14" profile. The base plate assemblies with risers that are illustrated below provide a convenient, low-cost option for increasing the clearance beneath the scale by increasing the profile between the top of the pier and the top of the approach.

Larry Behrens, Product Manager

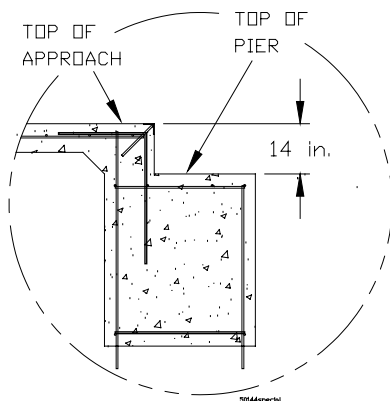

WARNING: Using base plates with the 2" or 4" risers requires an equal amount of adjustment to the foundation.

If the foundation is not adjusted, the scale deck will be sticking above the approach by the height of the riser (2" or 4").

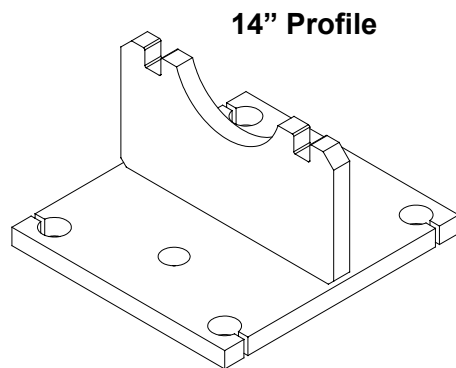

STANDARD BASE PLATE

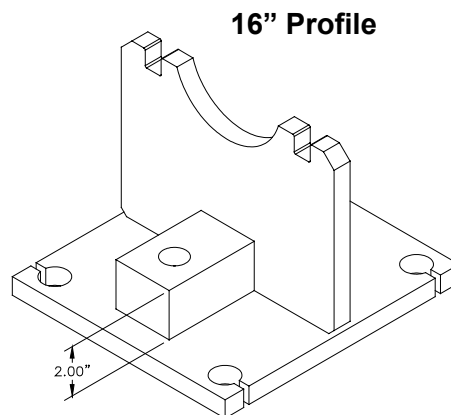

BASE PLATE WITH 2" RISER

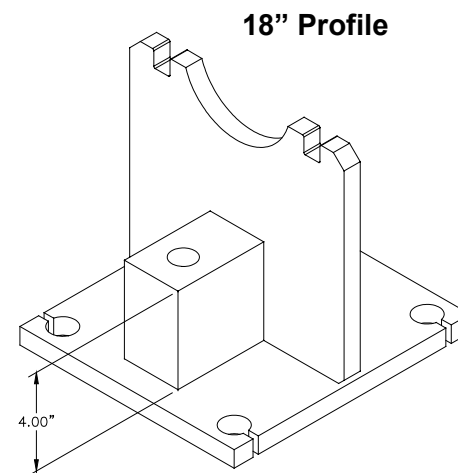

BASE PLATE WITH 4" RISER

LIST PRICING:

Truck Scale Orders
Service Part

56085-0018

Included
\$105.00 ea

56145-0016

\$25.00 ea
\$130.00 ea

56145-0024

\$35.00 ea
\$140.00 ea